

SF SERIES

SF

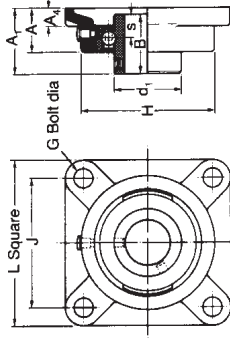

SF-A



SF-FC

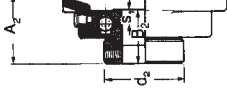

SF-DEC

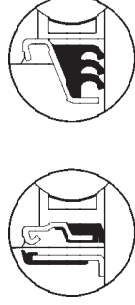

Bearing inserts with flinger seals shown on pages 91 and 92 can be fitted into these housings. The unit reference has the suffix 'FS', e.g. SF19/16FS.

Triple seal bearing inserts shown on pages 88 to 90 can be fitted into these housings. The unit reference has a prefix 'T', e.g. TSF19/16.

Shaft diameter	RHP designation		Basic bearing insert	Casting Dimensions											Rec. max. speed	Mass (approx.)								
	mm	inches		L	H	J	G	A	A1	B	B1	B2	B3	s			s1	sz	d1	d2	C <sub>r</sub>	C <sub>or</sub>	newtons	rev/min
12	SF12	SF12EC	1017	76.2	52.50	54.00	10	24.6	32.87															
15	SF15	SF15EC		3.000	2.067	2.126	3/8	969	1.294															
16	SF16	SF16EC																						
17	SF17	SF17EC																						
17	SF17	SF17EC																						
20	SF20	SF20EC	1020	85.7	60.3	63.5	10	27.8	37.26															
20	SF20	SF20EC		3.374	2.374	2.500	3/8	1.094	1.467															
25	SF25	SF25EC	1025	95.3	68.0	70.00	10	28.6	38.84															
25	SF25	SF25EC		3.752	2.677	2.756	7/16	1.126	1.529															
25	SF25	SF25EC																						
25	SF25	SF25EC																						
30	SF30	SF30EC	1030	108.0	82.6	82.50	10	29.8	42.21															
30	SF30	SF30EC		4.252	3.252	3.248	7/16	1.173	1.662															
30	SF30	SF30EC																						
30	SF30	SF30EC																						
35	SF35	SF35EC	1035	117.5	95.3	92.00	12	31.4	46.41															
35	SF35	SF35EC		4.626	3.752	3.622	1/2	1.236	1.827															
35	SF35	SF35EC																						
35	SF35	SF35EC																						
35	SF35	SF35EC																						
40	SF40	SF40EC	1040	130.2	101.6	101.50	12	34.9	54.18															
40	SF40	SF40EC		5.126	4.000	3.996	1/2	1.374	2.133															
45	SF45	SF45EC	1045	136.5	111.1	105.00	16	35.3	54.18															
45	SF45	SF45EC		5.374	4.374	4.134	5/8	1.390	2.133															
45	SF45	SF45EC																						
45	SF45	SF45EC																						
50	SF50	SF50EC	1050	142.9	115.9	111.00	16	39.7	60.53															
50	SF50	SF50EC		5.626	4.563	4.370	5/8	1.563	2.383															
50	SF50	SF50EC																						
50	SF50	SF50EC																						
55	SF55	SF55EC	1055	161.9	127.0	130.00	16	43.7	64.31															
55	SF55	SF55EC		6.374	5.000	5.118	5/8	1.720	2.532															
55	SF55	SF55EC																						
55	SF55	SF55EC																						
60	SF60	SF60EC	1060	174.5	138.1	143.00	16	47.6	73.69															
60	SF60	SF60EC		6.870	5.437	5.630	5/8	1.874	2.901															
60	SF60	SF60EC																						
60	SF60	SF60EC																						
65	SF65	SF65EC	1065	174.5	149.5	143.00	16	47.6	73.69															
65	SF65	SF65EC		6.870	5.886	5.630	5/8	1.874	2.901															
65	SF65	SF65EC																						
65	SF65	SF65EC																						
70	SF70	SF70EC	1070	187.5	155.5	149.22	16	47.6	77.72															
70	SF70	SF70EC		7.382	6.122	5.875	5/8	1.874	3.060															
70	SF70	SF70EC																						
70	SF70	SF70EC																						
75	SF75	SF75EC	1075	196.5	158.5	152.40	20	51.3	80.90															
75	SF75	SF75EC		7.736	6.240	6.000	3/4	2.020	3.185															
75	SF75	SF75EC																						
75	SF75	SF75EC																						

Please check availability